

# ETC® Setup Guide

## Gio Keycap Upgrade Kit



This guide outlines the removal and installation of the Gio keycaps (part number 4240K1020) that have changed with software version 1.9.11.

### Tools Required:

- Keycap Puller
- Small Needle Nose Pliers (Not Provided)

### Instructions

 **WARNING:** *Before removing and installing keycaps, you must power down your console.*

Step 1: To remove existing keycaps, gently place the keycap puller around the keycap and pull straight up while squeezing the puller.

 **Note:** *It is helpful to remove the center keycap first to have room to remove the outside keycaps.*

Step 2: Once the keycap is removed, a white plunger will be left behind. Use the needle nose pliers to remove the plunger. You will need to use some force to remove the plunger.

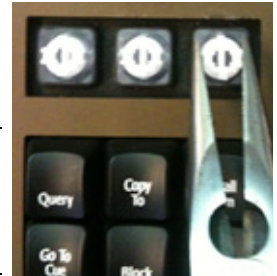

 **Note:** *It is important to not reuse the original plunger for the new keycap. The new keycaps each have their own plungers, and this is to ensure that they will be properly flush with the other keycaps.*

Step 3: Repeat steps 1 and 2 for each of the six keycaps.

Step 4: Place the new keycaps with plungers in the order shown in the below illustration.

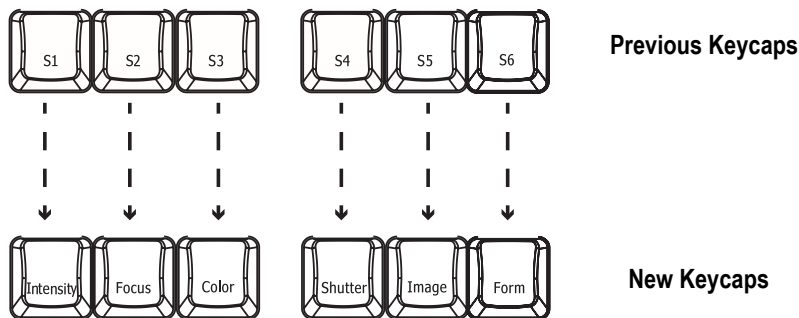

Step 5: Once each keycap is in place, firmly press down on each of the keycaps one at a time to properly secure.



Corporate Headquarters ■ 3031 Pleasant View Road, P.O. Box 620979, Middleton, Wisconsin 53562-0979 USA ■ Tel +608 831 4116 ■ Fax +608 836 1736  
London, UK ■ Unit 26-28, Victoria Industrial Estate, Victoria Road, London W3 6UU, UK ■ Tel +44 (0)20 8896 1000 ■ Fax +44 (0)20 8896 2000  
Rome, IT ■ Via Pieve Torina, 48, 00156 Rome, Italy ■ Tel +39 (06) 32 111 683 ■ Fax +44 (0) 20 8752 8486  
Holzkirchen, DE ■ Ohmstrasse 3, 83607 Holzkirchen, Germany ■ Tel +49 (80 24) 47 00-0 ■ Fax +49 (80 24) 47 00-3 00  
Hong Kong ■ Rm 1801, 18/F, Tower 1 Phase 1, Enterprise Square, 9 Sheung Yuet Road, Kowloon Bay, Kowloon, Hong Kong ■ Tel +852 2799 1220 ■ Fax +852 2799 9325  
Service: (Americas) [service@etconnect.com](mailto:service@etconnect.com) ■ (UK) [service@etceurope.com](mailto:service@etceurope.com) ■ (DE) [techserv-hoki@etconnect.com](mailto:techserv-hoki@etconnect.com) ■ (Asia) [service@etcasia.com](mailto:service@etcasia.com)  
Web: [www.etconnect.com](http://www.etconnect.com) ■ Copyright © 2012 ETC. All Rights Reserved. ■ Product information and specifications subject to change.  
© 4240M2300 ■ Rev A ■ Released 2012-05 ■ ETC intends for this document to be printed in its entirety.